

SR 141 IMPROVEMENTS, I-95 INTERCHANGE TO JAY DRIVE

DETOUR PLAN D RAMP H CLOSED

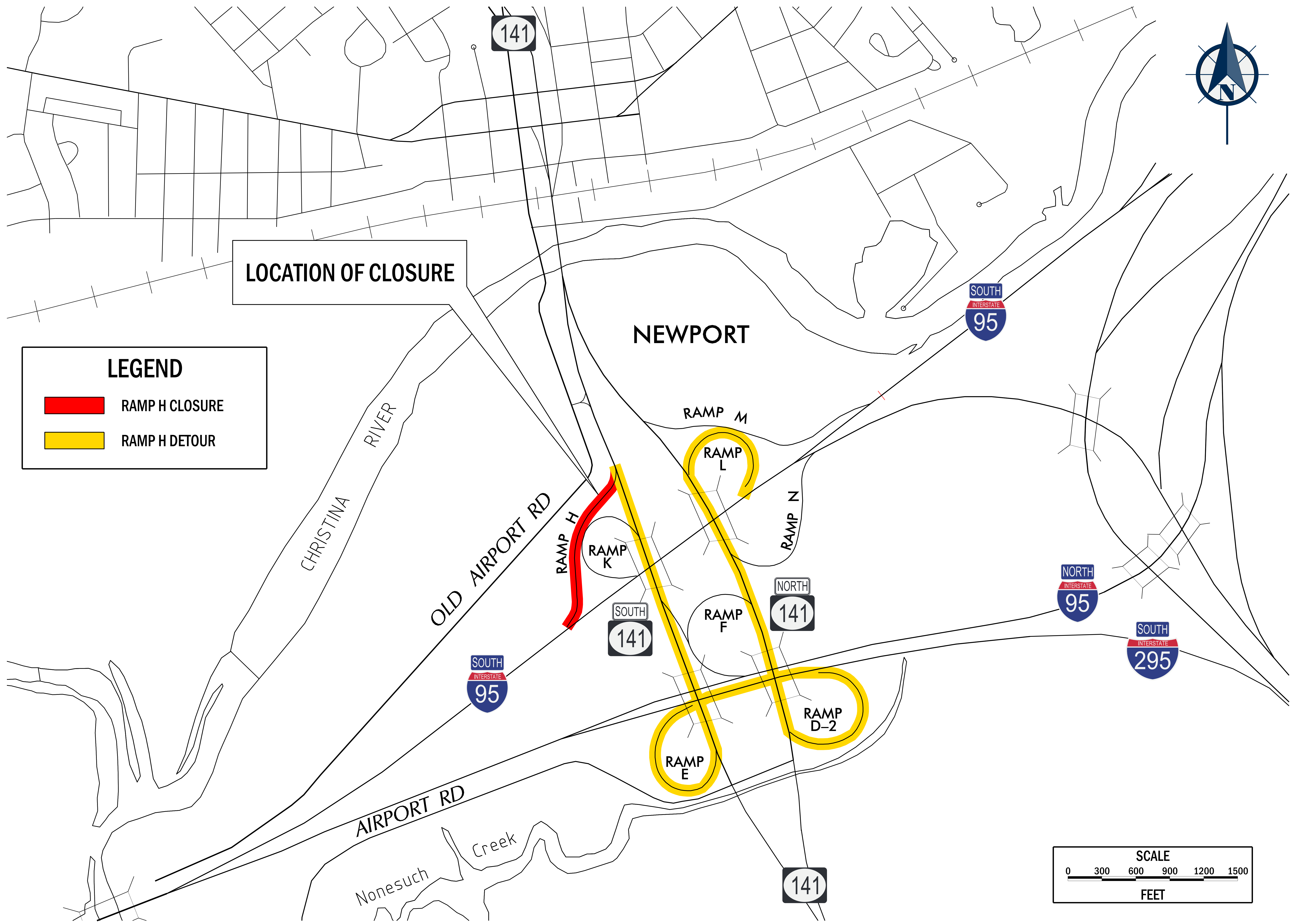
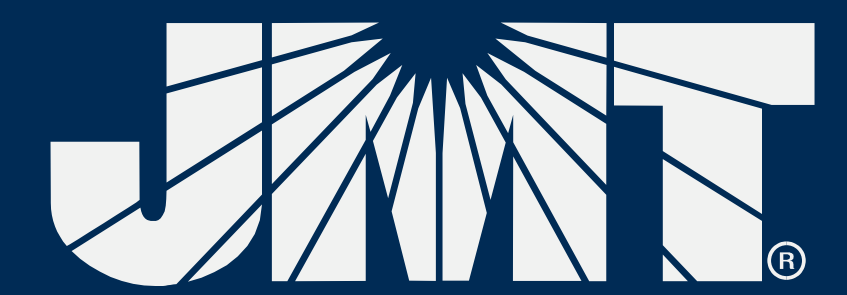

PLOTTED BY: MONTES DATE: 6/22/2020
FILE LOCATION: O:\MS\06272-019-195-ABD_S&L\NET\CAD\PRESENTATION\SR_141_DETOUR_PLAN_D_RAMP_H_CLOSED.dwg

SR 141 IMPROVEMENTS, I-95 INTERCHANGE TO JAY DRIVE - DETOUR PLAN D RAMP H CLOSED - JUNE 2020

JUNE 2020